

264

265

266

N 43-59 E 95.0

IN

IN

10' DRAINAGE EASEMENT



FILED  
GREENVILLE CO. S.C.  
JUN 13 11 20 AM 1986  
JONNIE S. TANKERSLEY  
R.M.C.

N 46-07 W 135.0

348

349

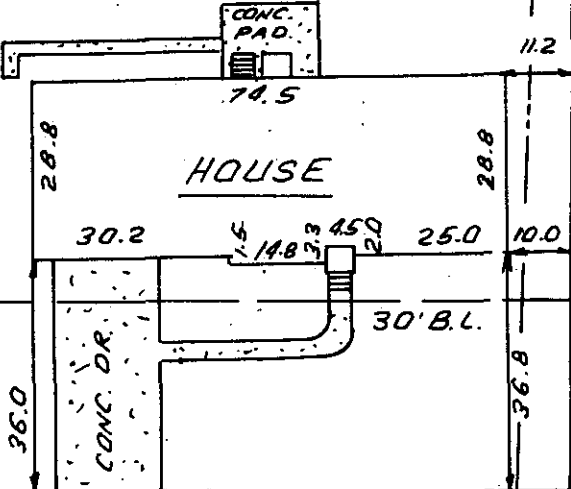

832' ± TO  
MARCHANT RD.

S 43-30 W 95.0

41854

LADBROKE ROAD

JUN 13 1986

12-V-67

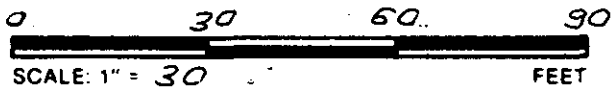

NOTE: 5' DRAINAGE & UTILITY EASEMENT  
ALONG EACH SIDE OF ALL SIDE & REAR  
LOT LINES.

THIS IS TO CERTIFY THAT THE PROPERTY SHOWN ON THIS PLAT WAS SURVEYED UNDER MY DIRECT SUPERVISION. PROPERTY LINES AND IMPROVEMENTS SHOWN ARE LOCATED CORRECTLY AND THAT NO VISIBLE ENCROACHMENTS EXIST UNLESS OTHERWISE SHOWN. THIS PROPERTY IS NOT LOCATED IN A DESIGNATED FLOOD HAZARD AREA.

**STATE OF SOUTH CAROLINA  
GREENVILLE COUNTY**

**FREELAND-CLINKSCALES  
& ASSOCIATES, INC.**  
Engineers • Land Surveyors  
323 WEST STONE AVENUE  
GREENVILLE, S.C.  
(803) 271-4924

DEL NORTE ESTATES  
SEC. 3; LOT 348  
PROPERTY OF  
BRADLEY C. TAYLOR  
JODI M. TAYLOR

PLAT BOOK	4N-14
DEED BOOK	11.10-9
TAX MAP	
PARTY CHIEF	J.P.S.
DRAWN	I.R.
DATE	JUNE-12-86
DWG. NO.	15483

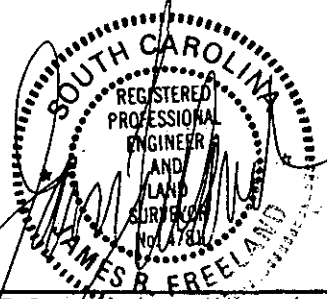

RLS: JAMES R. FREELAND  
NO: 4781

30710-2 UN13 86 109